

The background image shows a logging operation in a forest. A yellow PONSSE harvester is positioned on the right, with its grapple holding a log. In the foreground, there is a large stack of cut logs. The scene is dimly lit, with the harvester's headlights providing the main source of illumination. The PONSSE logo is centered at the top of the image.

PONSSE

TECHNICAL DATA

Technical data, H8

	H8	H8 Top Saw
Weight, min. (without rotator)	1250 kg	1450 mm
Length	1500 mm	1730 mm
Height w/o rotator.	1680 mm	1760 mm
Width	1650 mm	1650 mm
Power consumption	130-140 kW	
Operating pressure	28 Mpa	
Oil flow requirement	300 l/min	
Rotator	AV17/H182 indexator or RH3016 Black bruin	
Measuring and control automatics:	Ponsse Opti4G	
Saw unit:	Hydraulic chain saw	
Saw motor	30/32 cc	10cc tops saw motor
Power	45 kW	
Saw bar length	820 / 900 mm	640 mm
Chain speed	40 m/s	
Chain pitch	0.404	0.404
Cutting diameter	720 / 800 mm	460 mm
Feeding unit:		
Feeding type	3 rollers	
Feeding motors	620/400cc 750/500cc	
Feeding force	30 kN 36kN	
Feeding speed	0 – 4.5 0 - 5 m/s	
Max. opening	740 mm	
Optimum tree range diameter	45mm – 650mm	

Delimiting unit: One bolted and adjustable (2cm) + 4 movable knives (+ 1 fixed rear knife)

Max. opening, front/rear 740/780 mm

Delimiting knives and feed rollers separately controllable, adjustable pressure for knives and rollers

Technical data, H8 main components

Main components

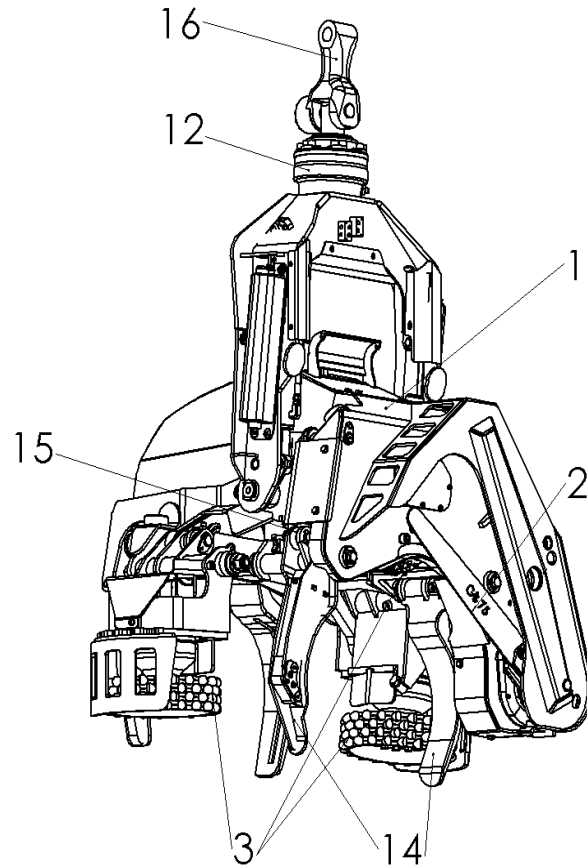

1. Chain lubricating oil container
2. Saw bar
3. Feed rollers
12. Rotator
14. Delimiting knives, rear
15. Delimiting knife cylinder, rear
16. Swing coupling

Technical data, H8 main components

Main components

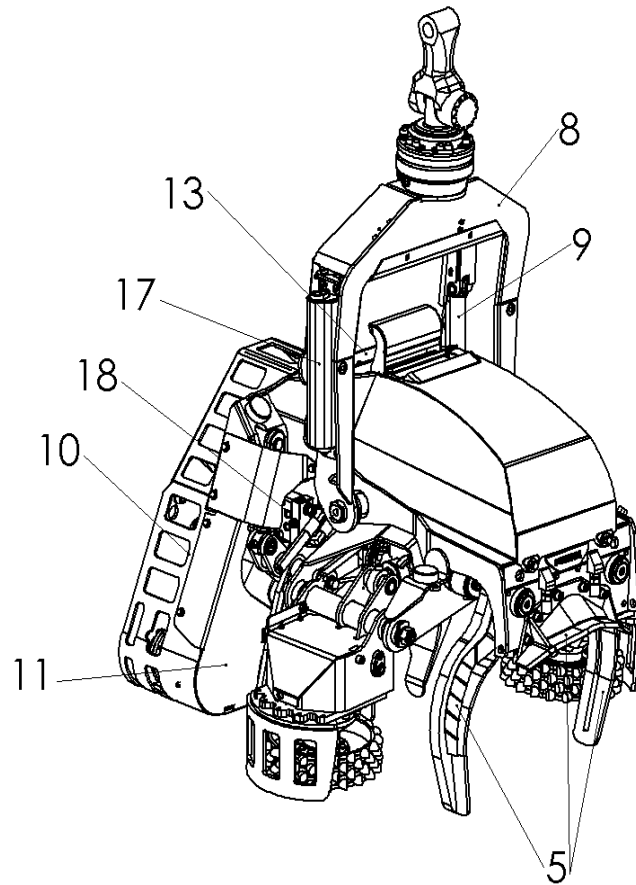

5. Delimiting knives, front

8. Tilt (pivot) frame

9. Tilt cylinder

10. Saw bar cylinder

11. Saw motor

13. Serial number

17. Color container

18. Feed motors

H8 options

- Saw motor: parker or bucher
- Feed roller options
- Processing knives
- Saw chain grease lubrication
- Rotator: Indexator / black bruin
- Stump treatment
- Color marking (Ponsse or SuperMark),
- Saw box lights
- Find-end sensor
- Opti control systems & GPS
- Heavy-duty tilt frame
- Connection hoses and rotating swivel connectors
- Measuring wheel hydraulic intake
- ORFS hydraulic fitting
- Ponsse Caliper3 electronic calipers

Comparison

	PONSSE H8/H8TS	JD H480C	Komatsu S172/ Logmax 7000C	Komatsu C164
Weight (starting)	From 1250 kg/1450kg	from 1350 kg >	From 1675 kg	From 1650 kg
Width (opened)	1650 mm	1880 mm	1689 mm	1905 mm
Lenth	1500 mm /1730 mm	NA	N/A	1690 mm
Saw unit:				
Saw motor	30/32 cc	19 cc	19 cc/30cc	19 cc
Saw bar length	820 mm (opt.900mm)	820 mm	750 / 825 / 900 mm	900 mm
Cutting diam. Max	720 mm (opt.800mm)	710 mm	650/ 720/ 750 mm	790 mm
Feeding unit:				
	3 rollers	4 rollers	2 rollers	4 rollers
Feeding power	30-36 kN	27/30 kN	35,9 / 41,7 kN	35,4 kN
Feeding speed	4.5-5 m/s	5.3/ 4.2 m/s	5,3 / 3,9 m/s	0 – 5 m/s
Delimiting unit:				
	2 fixed, 4 movable	2 fixed, 4 movable	4 movable	1 fixed, 4 movable
Max. opening (front/rollers/rear)	740 / 740 / 780 mm	680 / 680 / 710 mm	772 / 713 / NA mm	750 / 850 / 950 mm

The PONSSE logo is displayed in a yellow, segmented font at the top center of the page. The background of the entire page is a dark, atmospheric photograph of a logging site at night or in low light. A yellow PONSSE skidder is visible on the right, and a large stack of cut logs is in the foreground. The scene is illuminated by the machine's headlights, creating a misty or foggy atmosphere.

PONSSE

ATTACHMENT INSTALLATION DATA

Base machine recommendations

Harvester head model	Working pressure min / max. MPa	min / max flow L / min.	Recommended engine power KW	Recommended crane lifting capacity* kg	Harvester head min / max weight** kg	Recommended base machine weight kg
H5	28	160 - 235	≥ 70	≥ 1100	960 - 1040	10 000 - 13 000
H6	28	210 - 280	≥ 80	≥ 1250	1070 - 1165	13 000 - 16 000
H7	28	240 - 320	≥ 90	≥ 1450	1230 - 1350	16 000 - 22 000
H7HD	28	240 - 320	≥ 90	≥ 1500	1330 - 1450	20 000 - 25 000
H7euca	28	230 - 280	≥ 90	≥ 1450	1310 - 1390	20 000 - 25 000
H77, 670cc	28	260 - 320	≥ 90	≥ 1500	1300 - 1450	20 000 - 25 000
H77, 780cc	28	260 - 330	≥ 90	≥ 1500	1300 - 1450	20 000 - 25 000
H8HD, 750cc	28 - 31	260 - 330	≥ 120	≥ 1500	1340 - 1450	22 000 - 30 000
H8, 620cc	28 - 31	260 - 330	≥ 120	≥ 1500	1340 - 1450	22 000 - 30 000
H10, 1250cc	28 - 31	300 - 350	≥ 150	≥ 3100	2700 - 3000	28 000 - 40 000
H10, 940cc	28 - 31	300 - 340	≥ 150	≥ 3100	2700 - 3000	28 000 - 40 000

*Crane maximum reach crane lifting capacity.

**Max. weight = kg with rotator and connection hoses and extra equipments.