



PONSSE

TECHNICAL DATA



Technical data, H6

Weight, min. (without rotator)	1050 kg
Length	1445 mm
Height w/o rotator.	1530 mm
Width	1500 mm
Power consumption	130-140 kW
Operating pressure	28 Mpa
Oil flow requirement	300 l/min
Rotator	AV14/ AV17/H182 indexator or RH3016 Black bruin
Measuring and control automatics:	Ponsse Opti4G

Saw unit:	Hydraulic chain saw
Saw motor	30/32 cc
Power	45 kW
Saw bar length	750 mm
Chain speed	40 m/s
Chain pitch	0.404 "
Cutting diameter	640 mm

Feeding unit:	
Feeding type	3 rollers
Feeding motors	520/315 cc
Feeding force	25 kN
Feeding speed	0 – 6 m/s
Max. opening	600 mm

Optimum tree range diameter 45mm – 450mm

Delimiting unit: One bolted and adjustable (2cm) + 4 movable knives (+ 1 fixed rear knife)

Max. opening, front/rear 640/650 mm

Delimiting knives and feed rollers separately controllable, adjustable pressure for knives and rollers

Technical data, H6 main components

Main components

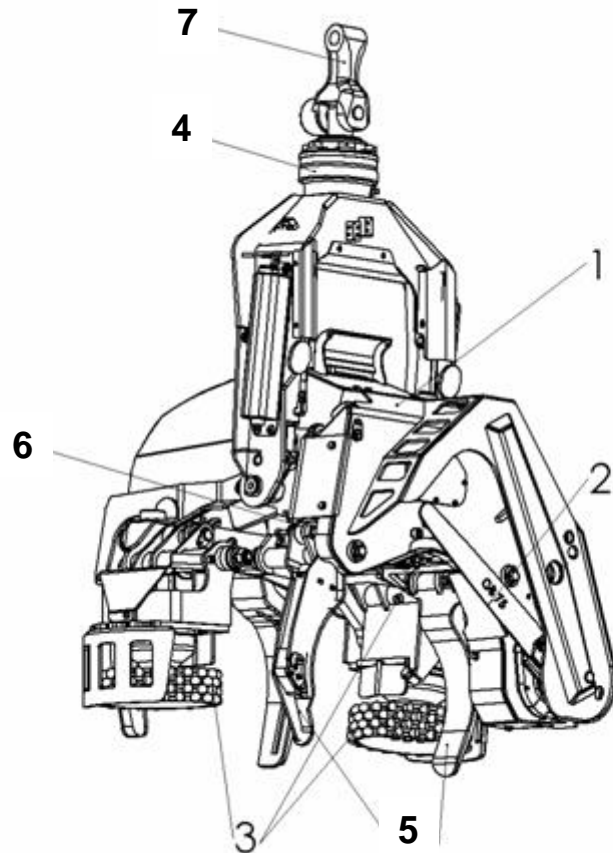

1. Lubrication oil tank
2. Saw blade
3. Feeding rollers
4. Rotator
5. Rear delimiting knives
6. Rear delimiting knives' cylinder
7. Link

Technical data, H6 main components

Main components

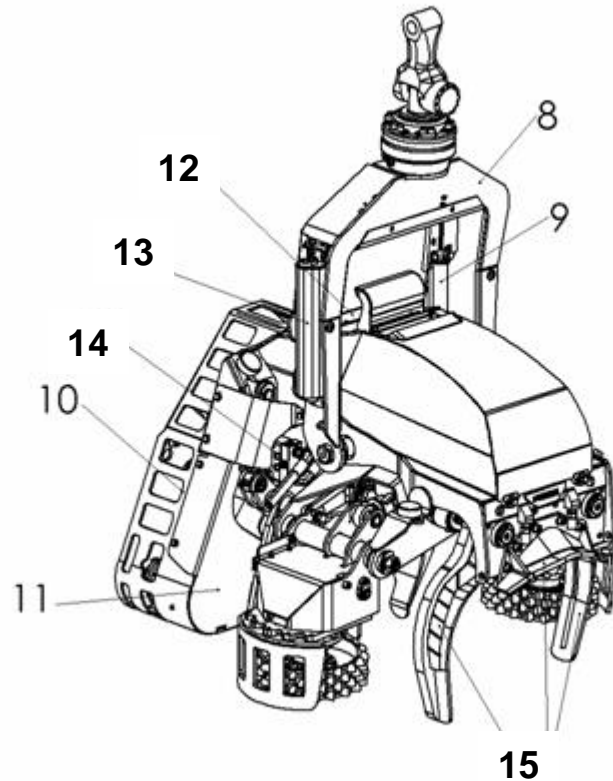

- 8. Pivot frame
- 9. Tilt cylinder
- 10. Saw cylinder
- 11. Saw motor
- 12. Manufacturing number
- 13. Color tank
- 14. Feeding motors
- 15. Front delimiting knives

H6 options

- Saw motor: parker or bucher
- Feed roller options
- Saw chain grease lubrication
- Rotator: Indexator / black bruin
- Stump treatment
- Color marking (Ponsse or SuperMark),
- Saw box lights
- Opti control systems & GPS
- Connection hoses and rotating swivel connectors
- Measuring wheel hydraulic intake
- ORFS hydraulic fitting
- Ponsse Caliper3 electronic calipers

Comparison

	PONSSE H6	JD H414	Komatsu S92/ Logmax 5000D	Komatsu C93
Weight (starting)	From 1050 kg	From 1100 kg	From 951 kg	From 976 kg
Width (opened)	1500 mm	1520 mm	1371 mm	1420 mm
Lenth	1445 mm	NA	N/A	1347 mm
Saw unit:				
Saw motor	30/32 cc	19 cc	19 cc	19 cc
Saw bar length	750 mm	750 mm	640 / 750 mm	750 mm
Cutting diam. Max	640 mm	620 mm	570 / 630 mm	600 mm
Feeding unit:				
	3 rollers	4 rollers	2 rollers	3 rollers
Feeding power	25 kN	27 kN	21,2 / 25,5 kN	20.1 / 25,3 kN
Feeding speed	0-6 m/s	0-6 m/s	0 – 4,1 / 0- 3,5 m/s	0 – 5 m/s
Delimiting unit:				
	2 fixed, 4 movable	2 fixed, 4 movable	4 movable (one is front knife)	1 fixed, 3 movable
Max. opening (front/rollers/rear)	640 / 600 / 650 mm	610 / 640 / 660 mm	535 / 519 / NA mm	600 / 550 / 700 mm

The PONSSE logo is displayed in a yellow, segmented font at the top center of the image. The background shows a logging site with a PONSSE harvester in the foreground, a skidder in the background, and a large stack of logs in the lower-left corner.

PONSSE

ATTACHMENT INSTALLATION DATA

Base machine recommendations

Harvester head model	Working pressure min / max. MPa	min / max flow L / min.	Recommended engine power KW	Recommended crane lifting capacity* kg	Harvester head min / max weight** kg	Recommended base machine weight kg
H5	28	160 - 235	≥ 70	≥ 1100	960 - 1040	10 000 - 13 000
H6	28	210 - 280	≥ 80	≥ 1250	1070 - 1165	13 000 - 16 000
H7	28	240 - 320	≥ 90	≥ 1450	1230 - 1350	16 000 - 22 000
H7HD	28	240 - 320	≥ 90	≥ 1500	1330 - 1450	20 000 - 25 000
H7euca	28	230 - 280	≥ 90	≥ 1450	1310 - 1390	20 000 - 25 000
H77, 670cc	28	260 - 320	≥ 90	≥ 1500	1300 - 1450	20 000 - 25 000
H77, 780cc	28	260 - 330	≥ 90	≥ 1500	1300 - 1450	20 000 - 25 000
H8HD, 750cc	28 - 31	260 - 330	≥ 120	≥ 1500	1340 - 1450	22 000 - 30 000
H8, 620cc	28 - 31	260 - 330	≥ 120	≥ 1500	1340 - 1450	22 000 - 30 000
H10, 1250cc	28 - 31	300 - 350	≥ 150	≥ 3100	2700 - 3000	28 000 - 40 000
H10, 940cc	28 - 31	300 - 340	≥ 150	≥ 3100	2700 - 3000	28 000 - 40 000

*Crane maximum reach crane lifting capacity.

**Max. weight = kg with rotator and connection hoses and extra equipments.